



Center For Women & Children

8111 S. Emerson Ave., Indianapolis



Franciscan HEALTH

Indianapolis

Shuttle Information

Parking shuttle services are available Monday through Friday from 6 a.m. to 8 p.m. To contact the shuttle directly, call (317) 416-8725.

Zone 1

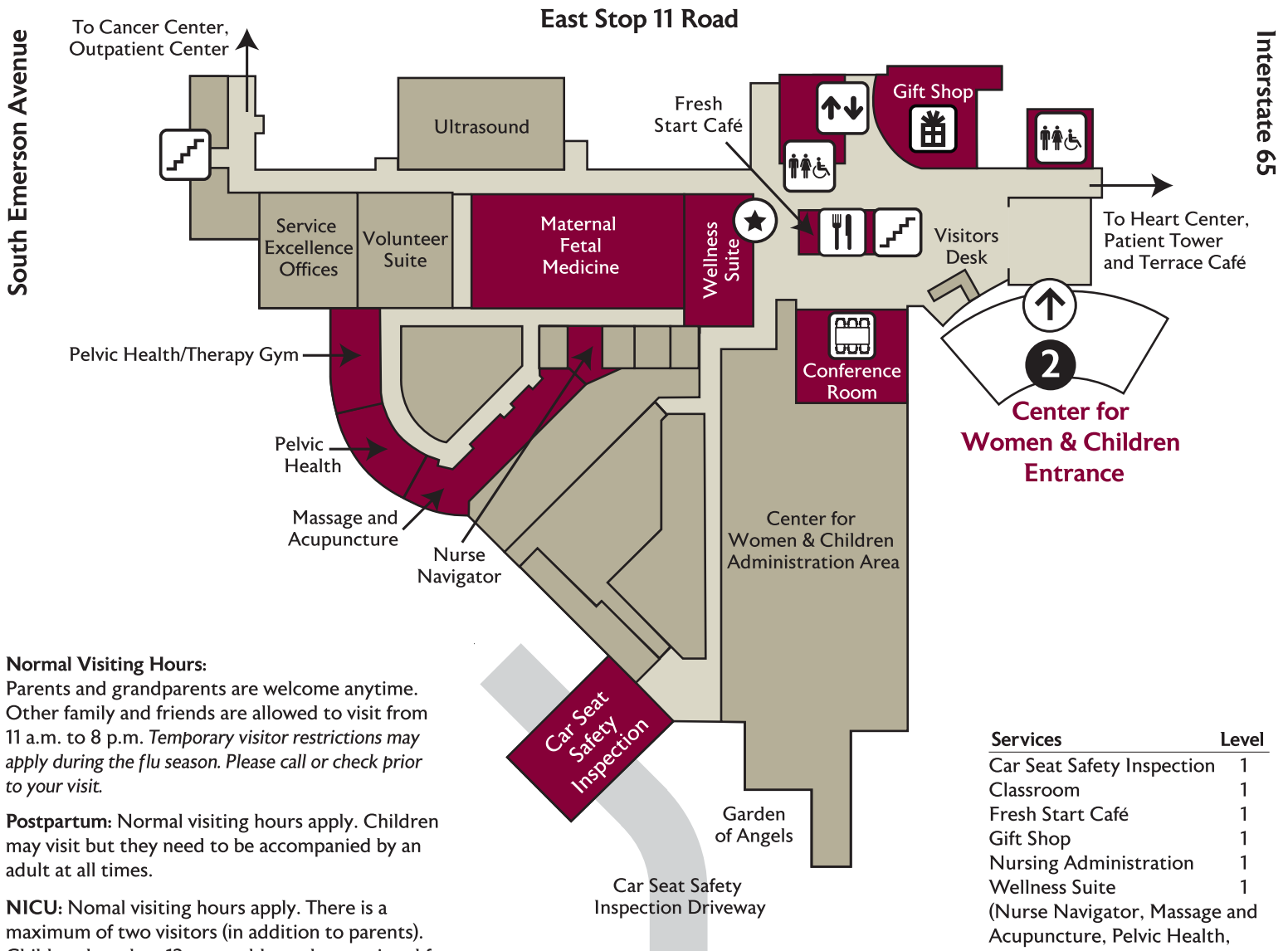

Normal Visiting Hours:

Parents and grandparents are welcome anytime. Other family and friends are allowed to visit from 11 a.m. to 8 p.m. *Temporary visitor restrictions may apply during the flu season. Please call or check prior to your visit.*

Postpartum: Normal visiting hours apply. Children may visit but they need to be accompanied by an adult at all times.

NICU: Normal visiting hours apply. There is a maximum of two visitors (in addition to parents). Children less than 12 years old may be restricted from October through early April due to flu season.

Pediatrics: Normal visiting hours apply. Children may visit but they need to be accompanied by an adult at all times. Visitors are required to wear appropriate barriers including gowns, gloves and masks to help prevent the spread of infection.

Services	Level
Car Seat Safety Inspection	1
Classroom	1
Fresh Start Café	1
Gift Shop	1
Nursing Administration	1
Wellness Suite	1
(Nurse Navigator, Massage and Acupuncture, Pelvic Health, Maternal Fetal Medicine)	

LEGEND

- Building Entrance
- Conference Room
- Gift Shop
- Stairs
- Suite Entrance
- Café
- Elevator
- Restroom
- Waiting Area

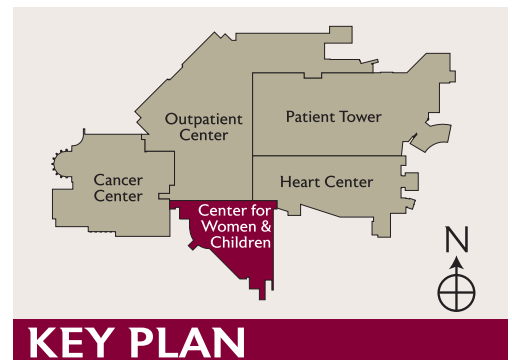

KEY PLAN



Center For Women & Children

Non-Clinical Services	Level
Lactation Clinic	2

Nursing Units	Level	Rooms
Antepartum	2	W201 - W208
Labor & Delivery	2	W209 - W221
OB Triage	2	W230 - W237
Perioperative	2	W238 - W240
Newborn Nursery	3	
Pediatrics	3	W301 - W310
Postpartum	3	W311 - W335
Neonatal Intensive Care	4	W412 - W436

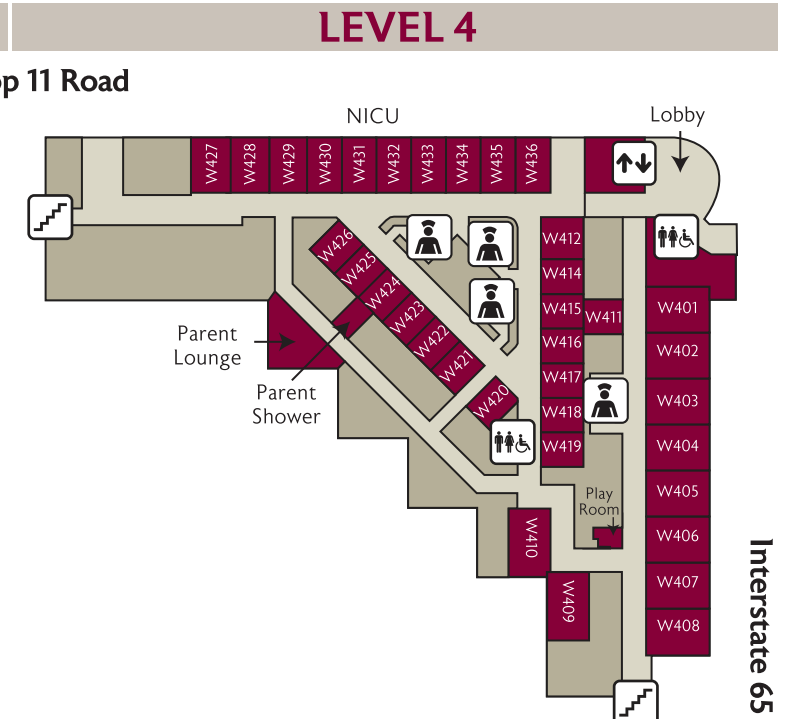
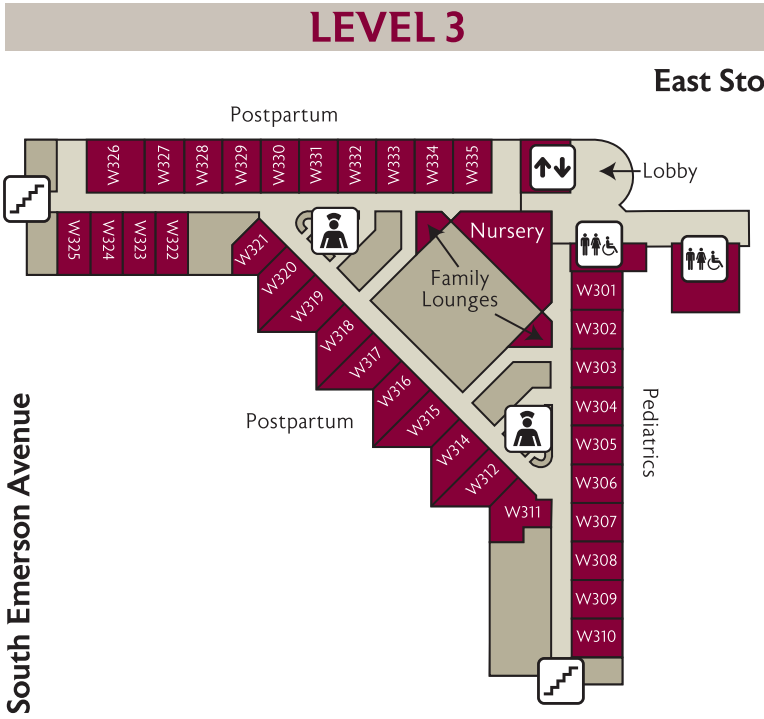
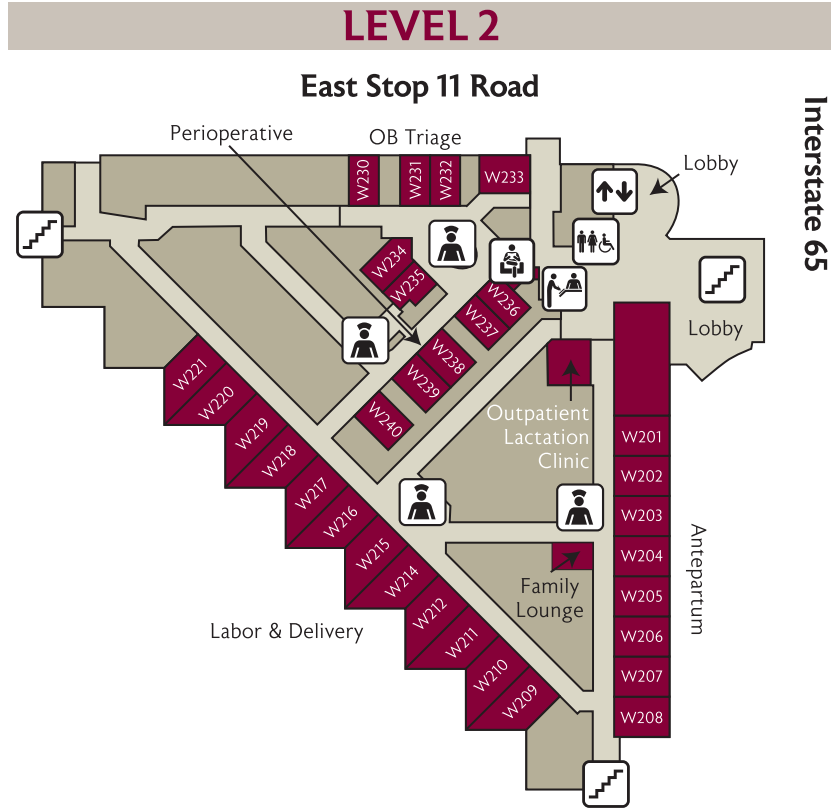

LEGEND

	Elevator		Stairs
	Nursing Station		Waiting Area
	Restroom		

